

Client: Mascaro

Cirba Solutions

Construction Field Offices

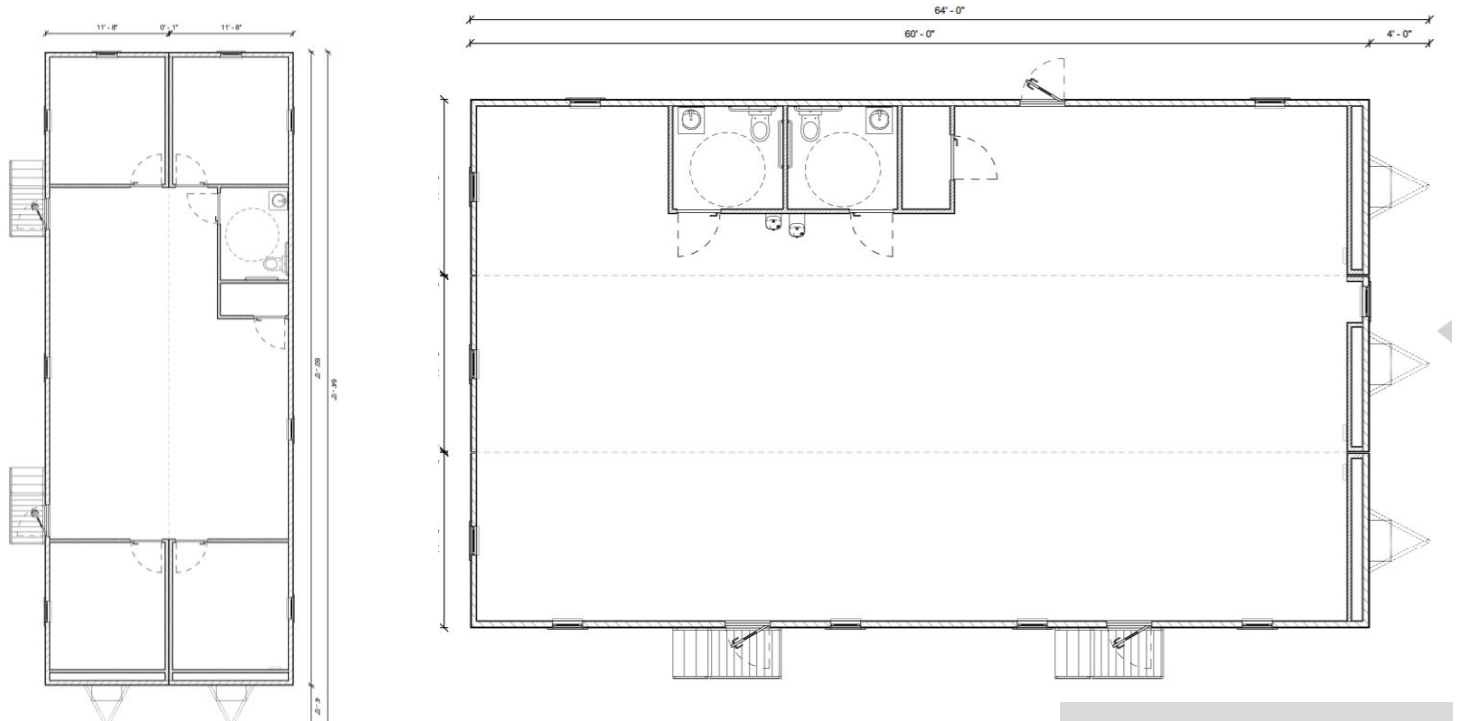

Triumph Modular provided an efficient and comprehensive solution for Mascaro's expanding project needs at an industrial manufacturing facility undergoing renovations. The lease arrangement included a 36-month term for a diverse set of modular units, creating a mini-campus on-site to accommodate various teams and functions.

The initial setup for Mascaro's team consisted of two 10' x 44' and one 8' x 32' mobile offices. As the project scope expanded with the award of phase 2, Triumph swapped out the original equipment and upgraded with two 24' x 64' modular buildings, a 3-piece **BLOCS™** modular complex, as well as two 12' x 64', a 10' x 44', and a 12' x 60' mobile office. This expanded setup provided ample space for Mascaro's growing team, including dedicated engineering, construction, and client personnel areas.

All units were brand new from the factory and equipped with fresh water and wastewater holding tanks. To enhance the functionality of the temporary workspace, Mascaro leased several Triumph Modular **Solutions** packages, which included Business Office and Business Bistro solutions.

The modular units were grouped together on-site, creating a cohesive mini-campus without requiring extensive site work. Triumph's efficient delivery and setup process allowed all buildings to be in place within two weeks. The installation included blocking, leveling, setting with tie-downs, and vinyl skirting.

This was Mascaro's first experience working with Triumph, and they were impressed by the bright, clean, and efficient units and the exceptional customer service.

Project Details

Location
Lancaster, OH

Square Feet
7,600

Modular Units
11

Lease Terms
36 Months